



HUNT GROUP

INTERNATIONAL ARMS & SECURITY

L36 LEVER ACTION SERIES

INSTRUCTION MANUAL

READ THE INSTRUCTIONS AND
WARNINGS IN THIS MANUAL
CAREFULLY BEFORE USING THIS
FIREARM

QUALITY CONTROL - WARRANTY CARD

Serial No. of weapon _____ Model _____

Manufacturer _____

Caliber _____ Year of manufacture _____ Barrel Length _____

Number of Cartridges and grams of cartridges tested _____

Chamber details _____

PURCHASER _____

Address _____

Purchase date _____

Signature _____

PLEASE SIGN AND RETURN THIS CARD TO VALIDATE WARRANTY



HUNT GROUP

INTERNATIONAL ARMS & SECURITY

**L36 LEVER ACTION
SERIES
INSTRUCTION MANUAL**

CARE AND MAINTENANCE OF YOUR L36 SHOTGUN

1- NEVER ALTER OR MODIFY YOUR SHOTGUN

This shotgun was produced under specific manufacturer guidelines and should not be changed under ANY circumstances. Altering the trigger, mechanical components, safety mechanisms, or using any other products other than those provided in the original box is **NOT RECOMMENDED** by the manufacturer, and could result in death, bodily harm, or compromising your safety or the safety of others. Any alteration made to the firearm also voids the factory warranty.

2- PROPER CARE AND MAINTENANCE

It is essential that regular maintenance and cleaning be performed to maintain the accuracy, function, and maximize the longevity of your firearm. Before cleaning **ALWAYS** perform a safety check to make sure that the firearm is unloaded prior to cleaning.

A GUN OWNER'S RESPONSIBILITY

As the owner of a firearm you have the responsibility and obligation of ensuring that any and all shooting activities are safe for everyone. This requires your personal commitment to carefully read, fully understand, and exercise the principles of proper firearm safety at all times.

DISCLAIMER

The firearm in which these safety rules apply is sold under the expressed conditions that the manufacturer accepts **NO LIABILITY** in part or whole for bodily injury, death, or property damage from:

- Improperly or carelessly handling the firearm.
- Using defective, improper caliber, hand-loaded, or reloaded ammunition.
- Inadequate maintenance of the shotgun resulting in corrosion or damage, negligence of malfunctions.
- Resale in contradiction of any applicable laws or regulations, altering or converting the firearm's original aesthetic, functioning mechanisms, accessories, or mechanical configuration
- Discharging with criminal intent or negligence.
- Failure to understand, adhere to, and follow the rules of firearm safety when using or handling the firearm.

Or any other circumstances outside the manufacturer's direct or immediate control.

FIREARM SAFETY

IMPORTANT WARNING : It is important for you to receive proper training from a competent firearms instructor or authority before beginning to shoot or when handling the firearm.

IMPORTANT WARNING : Failure to adhere to the rules of firearm safety can result in serious injury, death or destruction of property.

1-COMpletely READ AND UNDERSTAND YOUR OWNER'S MANUAL GUIDE-LINES BEFORE USING YOUR FIREARM. You should fully understand the function of all of the components and mechanisms of the firearm. Before you remove the firearm out of the box thoroughly read the owners manual on how to properly carry, handle, load, unload and store your new firearm. Know the rules of proper gun safety and exercise them at all times because failure to do so may result in death or injury to yourself or others. Because it is impossible to list every firearm situation or scenario, be aware that certain circumstances may require additional safety rules unique to a particular situation. In these cases, we recommend that use.

2) ALWAYS LEARN THE SPECIFIC MECHANICAL AND HANDLING CHARACTER-ISTIC OF YOUR SHOTGUN. Firearms are different thus it is important for you to understand how to properly carry, use and handle each one according to its specific guidelines. Before using any firearm, one must completely familiarize themselves with the type of firearm and its specific safe handling procedures for loading, unloading, carrying.

NEVER

- Give the shotgun to any person who has not thoroughly familiarized himself or herself with all of the information, safety rules and warnings in the owners manual.

3) ALWAYS KEEP THE FIREARM UNLOADED UNTIL READY TO USE. Firearms should be kept unloaded when not in use. Whenever you pick up a firearm, immediately keep the muzzle pointed in a safe direction and your fingers away from the trigger. Always inspect the chamber, barrel, feed mechanism and magazine carefully after unloading to be sure all live cartridges are cleared from the firearm after; 1) shooting, 2) before putting the firearm away, 3) putting it into a holster, 4) when not use and, 5) when handing it over to another person.

LOADING THE SHOTGUN

1) First, point the shotgun in a safe direction. Remember, a safe direction means that the gun is pointed so that even if it were to go off, it would not cause injury, damage or death. Always perform a safety check to make sure that the chamber is empty.

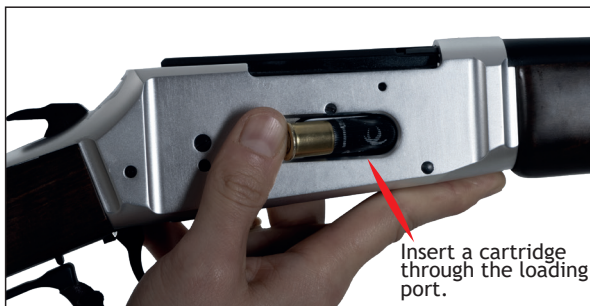

2) The hammer in the rebound position, press the spring cover on the loading port inward with the bullet tip of the first cartridge until all but the rim has entered the loading port. Insert the next cartridge in the same manner, using it to push the preceding cartridge into the magazine.

3) Repeat this procedure with each cartridge, pushing the last cartridge past the end of the spring cover.

4) Close the action by pulling the finger lever upward. Keep your fingers away from the trigger.

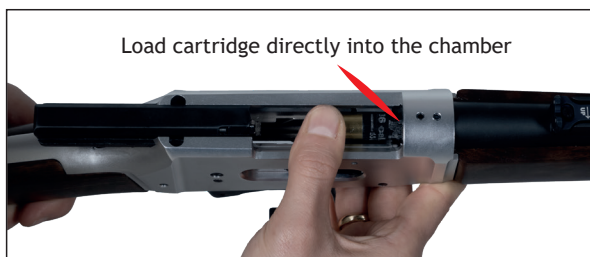

LOADING DIRECTLY TO THE CHAMBER

The chamber of your rifle may be loaded by placing a cartridge directly into the chamber through the opened action, or by transferring a cartridge that was previously loaded into the magazine to the chamber by operating the finger lever.

1) Open the action by pulling the finger lever downward and fully forward.

2) Insert a cartridge directly into the chamber.

3) Close the action by pulling the finger lever upward. Keep your fingers away from the trigger.

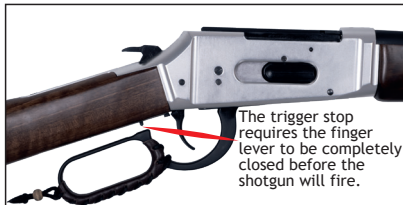

FIRING THE SHOTGUN

- 1) Load the chamber of the rifle as explained previously.
- 2) Immediately lower the hammer to the rebound position.
- 3) When shooting is imminent, use your thumb to draw the hammer back and into the full-cock position.
- 4) Take aim, and when on target, squeeze the trigger. After firing, release the trigger to the fully forward position.
- 5) To continue shooting, swing the finger lever fully down, extracting and ejecting the fired cartridge case from the chamber.
- 6) Close the action by returning the finger lever upward. The closing of the action will transfer a new cartridge from the magazine to the chamber, leaving the hammer in the full-cock, ready-to-fire position. If you wish to continue shooting, repeat steps 4-6. If you are finished shooting go immediately to step 7. You may continue shooting until the magazine is empty, at which time will need to either reload the magazine with cartridges (if shooting is imminent), or fully unload your rifle (if shooting is completed.)
- 7) Immediately lower the hammer to the rebound position.



UNLOADING THE SHOTGUN

- 1) Point the shotgun in a safe direction. Remember, a safe direction means that the gun is pointed so that even if it were to go off, it would not cause injury, damage or death.
- 2) Keep your fingers off the trigger.
- 3) Swing the finger lever completely downward. This will extract any cartridge from the chamber and eject it. Capture the cartridge and return the finger lever fully upward. Keep your fingers away from the trigger.
- 4) Continue to operate the finger lever in the same manner transferring all the remaining cartridges from the magazine to the chamber and then ejecting them out.
- 5) When cartridges no longer eject when you cycle the action, further assure that no cartridges remain by opening the action, depressing the carrier and visually checking the chamber, feed mechanism and magazine follower to be certain that the rifle is completely unloaded. After the last live cartridge is moved out of the magazine and ejected, immediately close the action and lower the hammer to the rebound position as explained previously.



ASSEMBLY / DISASSEMBLY

Your shotgun comes fully assembly in the box. No assembly to the rifle itself is required. No disassembly is required for normal maintenance.

If your shotgun requires disassembly for any reason (such as requiring extra cleaning after being dropped in water) it should be performed by a competent gunsmith, by one of our Authorized Repair Centers, or by our service facility.



HUNT GROUP
INTERNATIONAL ARMS & SECURITY



BE COURTEOUS

When shooting or hunting always acquire the permission of the landowner. Respect the land. Do not litter, use gates when possible, leave open and closed gates closed. Drive vehicles only where advance permission has been granted and always express gratitude for use of another person's land.

Offer your labour or game as repayment for the privilege of use. Remember you are helping develop a reputation for all sportsmen/sportswomen.

HUNT GROUP SİLAH OTOM. SAN. ve TİC. LTD. ŞTİ.
Müftü Mahallesi 41117. Sokak A Blok No : 2B - Beyşehir - KONYA / TURKEY
Web : www.huntgrouparms.com
E-mail : export@huntgrouparms.com